

Hero of Twilight instruction manual

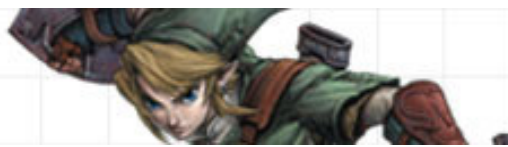

step 1

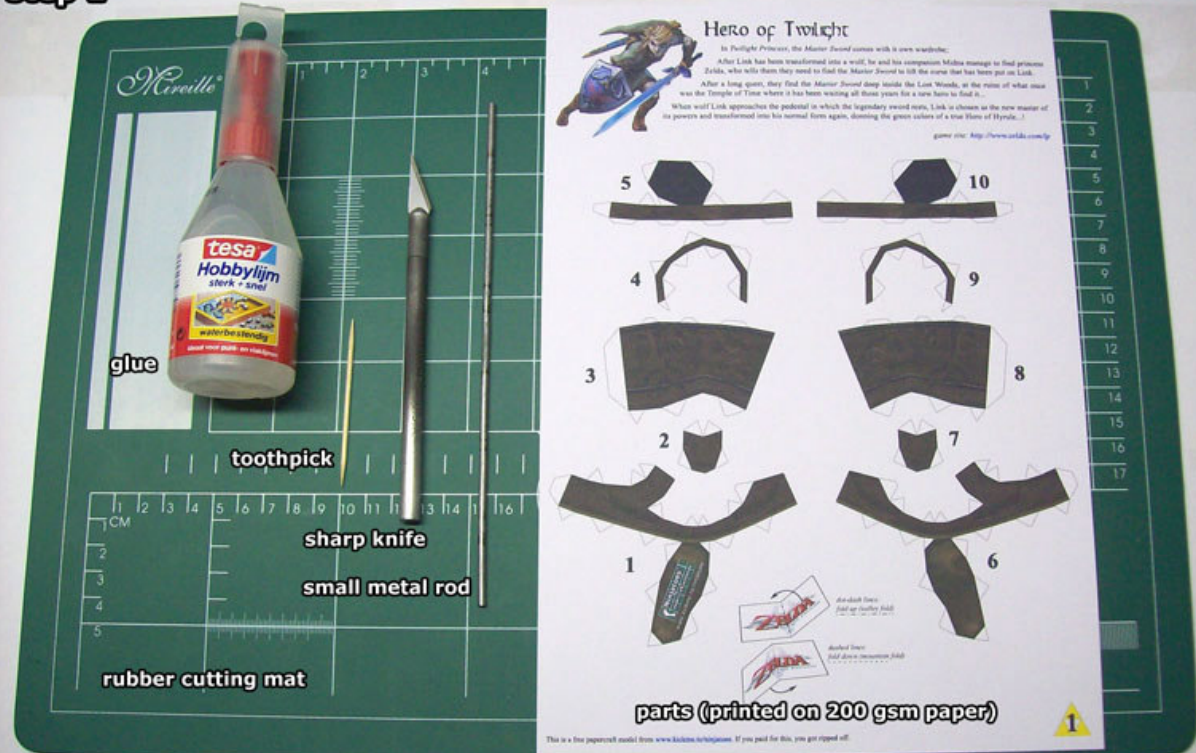

The bare essentials for papercrafting are a knife and glue (and the parts, preferably printed on thicker paper) but any other tools like a toothpick and a small metal rod will help you reach places where your fingers can't... (and a cutting mat will protect your desktop so you won't ruin it ;o)

step 2



Parts that seem difficult at first, can be easy if you pre-shape the part first, and assemble them in a particular order. For part 1 for example, I find it easiest to first glue one of the sides around the sole of the boot...

step 3



...then the other side...

step 4



...and last but not least, the "bridge" from one side to the other.

step 5



Cut out and pre-shape part 2, and then glue it to part 1 to close the hole on the front of the boot.

step 6



step 7



step 8



step 9



step 10



step 11

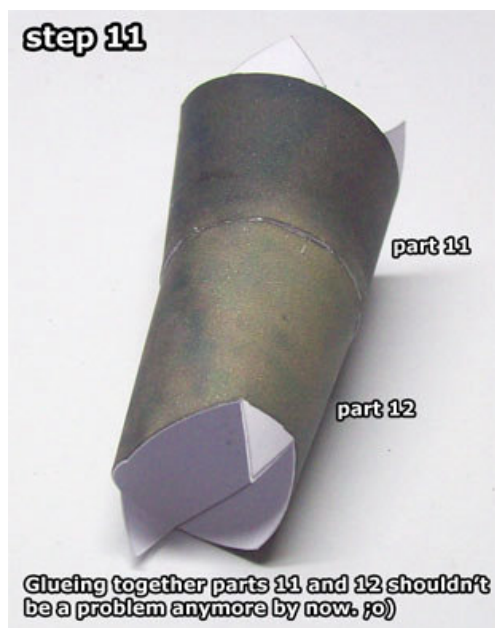

step 13



step 12



step 14



Glue together parts 14-16 the same way. Take note of the grey tab that you need to fold all the way over...

step 15

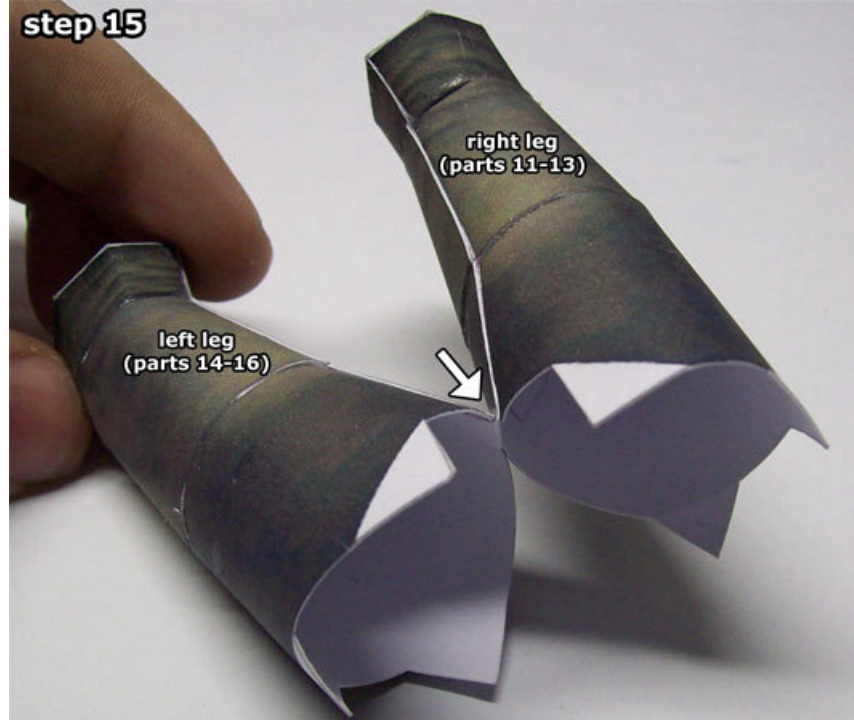

...so that you can use it to glue together the right and leg legs in the middle as shown here.

step 16



After pre-shaping part 17, glue the back together to get the shape as shown here...

step 17



I found it easiest to first glue on the front (taking extra care on the larger glueing tabs on the "groin area") and the sides...

step 18



...leaving open the back for now...

step 19



...only closing the back after you glued the front and sides together properly.

step 20



Now you can glue the boots to the legs (don't mix up left and right: the right boot is the one with the Ninjatoes logo ;o)

The seams on the backside should line up, but the important thing is to glue on the boots so the soles rest flat on the ground, so that he won't fall over.

step 21



Now assemble and glue together parts 18 and 19...

step 22



And then simply place the chainmail skirt over the legs, glueing the glueing tabs of part 18 on top of those on part 17.

step 23



Pre-shape and glue together parts 20-22 as shown here.

step 24



After assembling part 23, glue it on as well.

step 25



Glue the bottom part of the tunic over the chainmail skirt, glueing the backside of the belt to the glueing tabs.

step 26



Glue the ends of part 24 together to make the bottom part of the torso, and then glue on part 25 to the front and part 26 to the back.

step 27



To glue on part 27, I found it easiest to first glue the ends together at the back, then glue on the frontside first...

step 28



step 29



step 30



step 31



step 32



step 33



step 34



Align the seam at the back of part 31 with the seam at the back of part 27.

step 35



part 32

When glueing on part 32, leave open the bottom as long as possible...

step 36



...until you glue the torso to the legs like so.

step 37



part 33

part 34

part 35

part 36

part 37

Assemble all the sepearte parts for the arm (33-37) as shown here...

step 38



part 33

parts 34-35

parts 36-37

...and then glue them together like so.

step 39



part 38

part 39-40

part 41-42

Do the same for parts 38-42 on the other arm.

step 41



step 40



Fold double part 43, and curve it before the glue has dried...

step 42

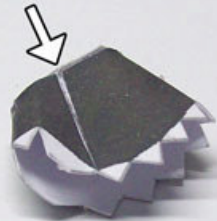

Pre-shape and glue together part 33. The large glueing tab needs to be valley folded, so you can shape the base of the thumb.

step 43

part 34



part 35



The fingers are all made up from small cylinders. They're small, but not too difficult to assemble if you roll them around a toothpick first: www.youtube.com/watch?v=3ph7ayEs1RA

step 44

part 34

part 35



Glue them to the base of the thumb as shown here.

step 46

parts 37-37

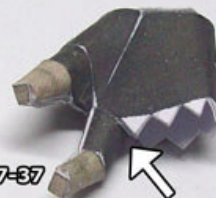

...before glueing them to the hand like so. The easiest way to do this is to put a fair amount of glue in the open end of the finger, and then press them onto the glueing tabs. The extra glueing tab is used to glue on the next finger.

step 45

part 36

part 37



For the rest of the fingers, I found it easiest to glue the two parts for each finger together first...

step 47



parts 38-39

Just keep glueing on the fingers one...

step 48



parts 40-41

...by one...

step 49



parts 42-43

...by one.

step 50



right hand
(parts 33-43)

Then glue the hand to Link's arm. The position of the thumb will tell you on which side (or you can just check the picture).

step 51

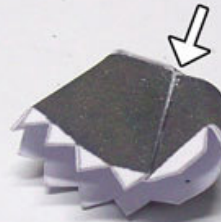

The left hand goes together the same way. First assemble part 44 (minding the valley fold again to shape the base of the thumb).

step 52



parts 45-46

Then glue on the thumb (parts 45-46)...

step 53



...and then all the other fingers.

step 54

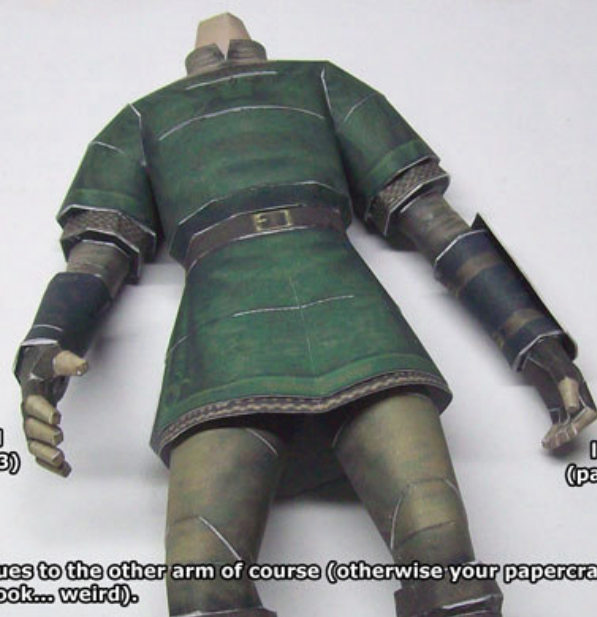

right hand
(parts 33-43)

left hand
(parts 34-54)

This hand glues to the other arm of course (otherwise your papercraft model of Link would look... weird).

step 55



Now cut out and assemble part 55.

step 56

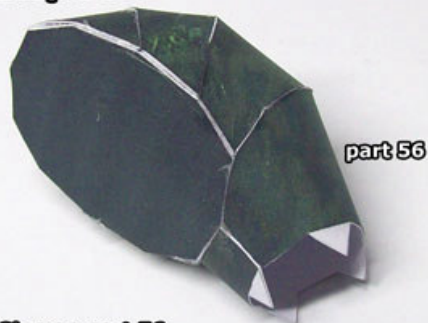

Glue on part 56...

step 57



...and then glue on parts 57 and 58.

step 58

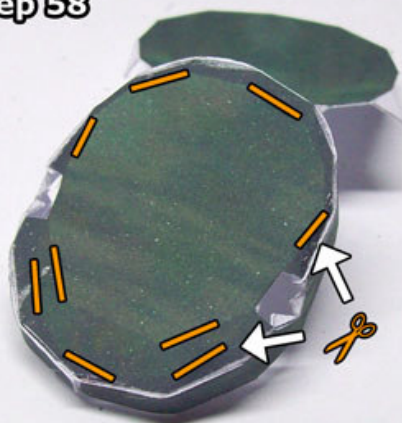

It is easiest to cut the slits on part 59 before you cut out and assemble the part.

step 59



The cap (parts 55-58) needs to be glued on top of part 59, so that part 59 sticks out a bit on the front and sides, but not at the back.

step 60



Pre-shape part 60, but take note that the grey coloured glueing tabs shouldn't be folded down...

step 61



Because those need to be inserted into the slits on the bottom of part 59.

step 62



Now pre-shape and assemble part 61...

step 63



step 64



step 65

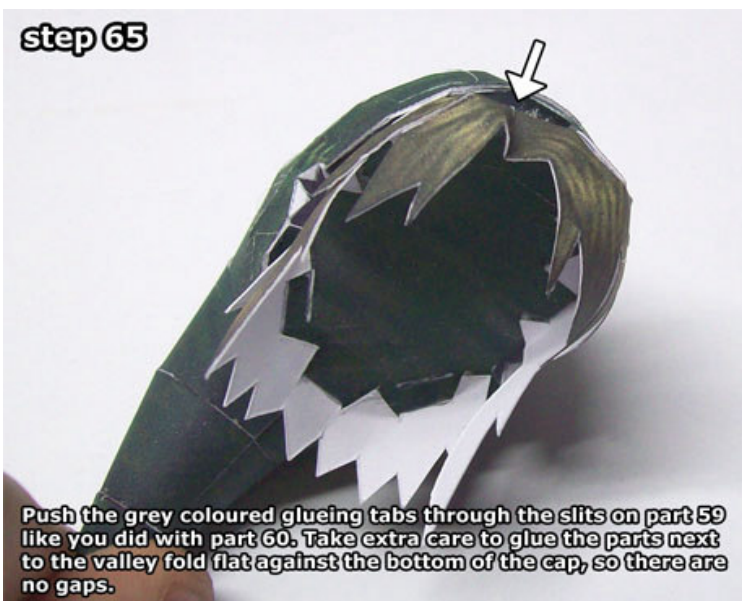

step 66

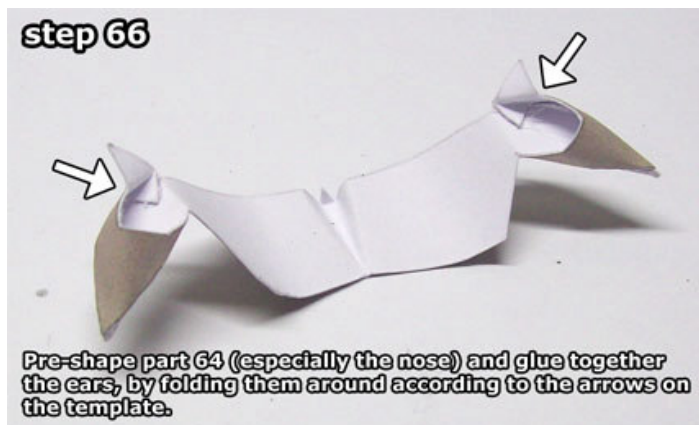

step 67



step 68



step 69



step 70



Glue the head to the cap using the two grey coloured glueing tabs at the back. The ears will fit into the notches on the sides, and the hair at the top of the head will fit underneath the hair on the cap. It doesn't need to be glued, except the part at the valley fold in the middle.

step 71

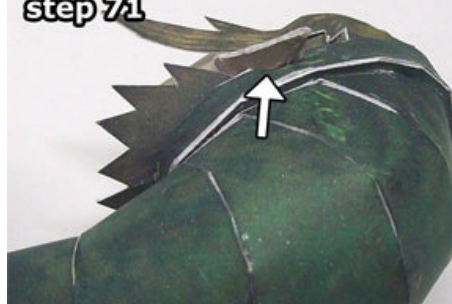

Make sure to apply some glue to the glueing tabs around the notches for the ears, and then gently press on the ears to glue them on tight.

step 72

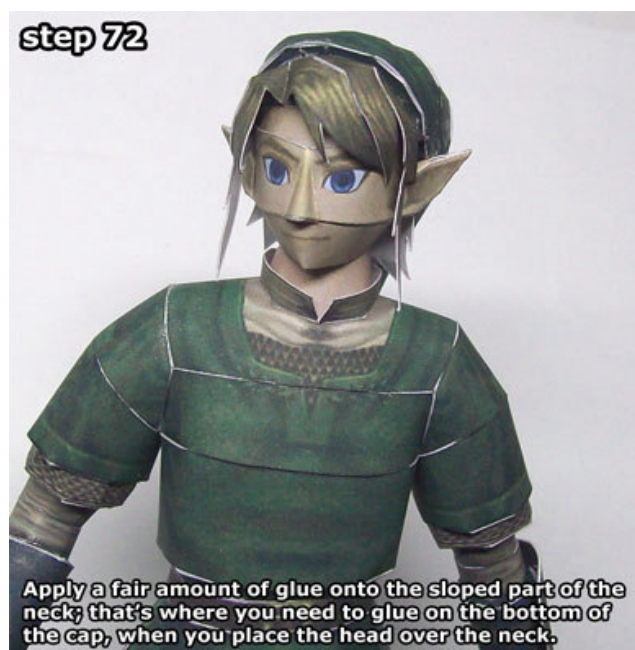

Apply a fair amount of glue onto the sloped part of the neck; that's where you need to glue on the bottom of the cap, when you place the head over the neck.

step 73



Lead part 69 underneath Link's right arm first, and then glue together the two ends on top of his left shoulder, and after that, the two ends underneath his right arm.

step 75



...and 71 and glue them to Link's belt like so.

step 74



Now cut out and assemble parts 70...

step 76



Cut out and glue together part 72.

step 77



Then glue on part 73.

step 78

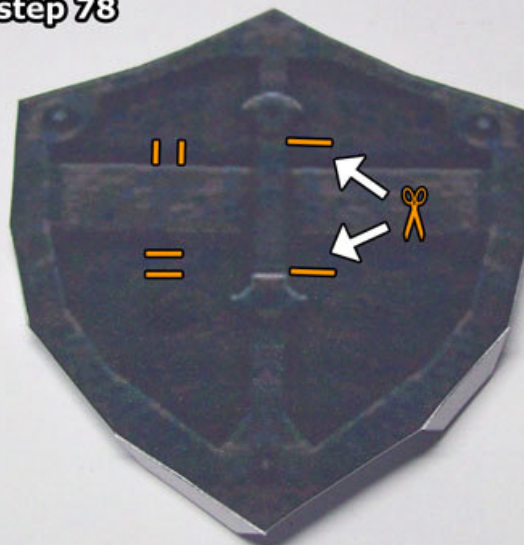

Now cut out part 74, including the little slits.

step 79

parts 75+76

Glue together parts 75 and 76 back-to-back (except the glueing tabs!) and curve them before the glue has dried.

step 80



Push the glueing tabs through the slits on part 74 (you'll know which ones) and then glue them down as shown here.

step 81

part 77

part 78

Cut out and assemble part 77 and pre-shape part 78...

step 82

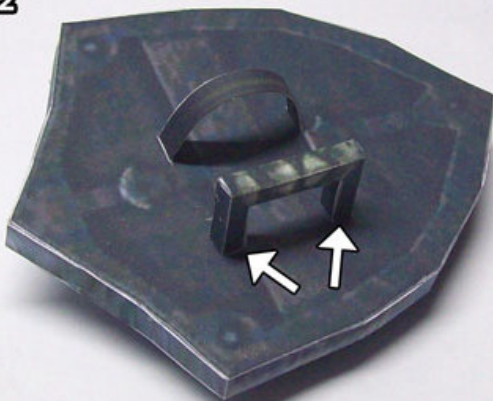

...glue them together and then glue the handle you made to part 74 using the tabs and slits like you did on parts 75 and 76. After that, glue part 74 to the front of the shield (part 72).

step 83



Now slide the brown strap over Link's right arm to place the handle in his hand as shown here (push the fingers together a bit if needed).

step 84

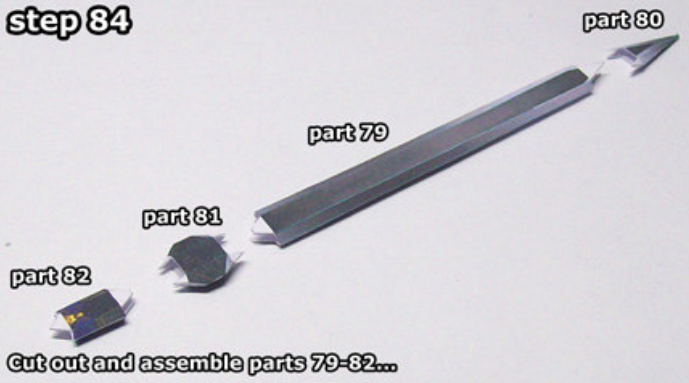

step 85

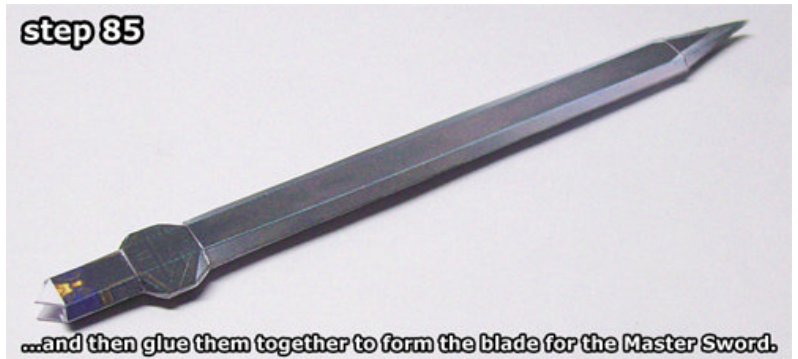

step 86

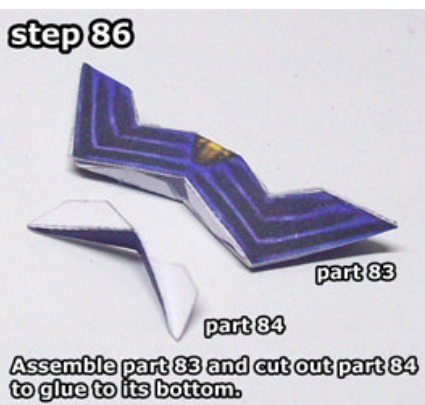

step 87



step 88



step 89



step 90



step 91



...and then place the Master Sword in Link's left hand.

step 92



Now cut out and glue together the final two parts...

step 93



...and then find a nice place for the assembled scabbard on Link's back as shown here.

step 94



And that's it, your Hero of Twilight is done!